

**Hanse 540e**

**Year:** 2007  
**Location:** Preveza, Greece  
**LOA:** 52' 10" (16.10m)  
**Beam:** 16' 1" (4.91m)  
**Draft:** 6' 5" (1.95m)

**Heads:** 5  
**Cabins:** 5  
**Berths:** 9  
**Keel:** Fin Keel  
**Engines:** 1

**Remarks:**

This Hanse 540E, designed by Judel & Vrolijk, is a very good example of a modern and comfortable racer/cruiser that can easily be managed by short-handed crew. She has wide, uncluttered teak decks, a sleek cabin top, an electro-hydraulic operated teak laid bathing platform, a transom garage and a big cockpit with twin wheel steering.

**€184,950** Tax Not Paid**E:** [info@nybbarcelona.com](mailto:info@nybbarcelona.com) **T:** [+34] 937978240[www.networkyachtbrokers.com](http://www.networkyachtbrokers.com) | over 700 boats listed

REF: 22588

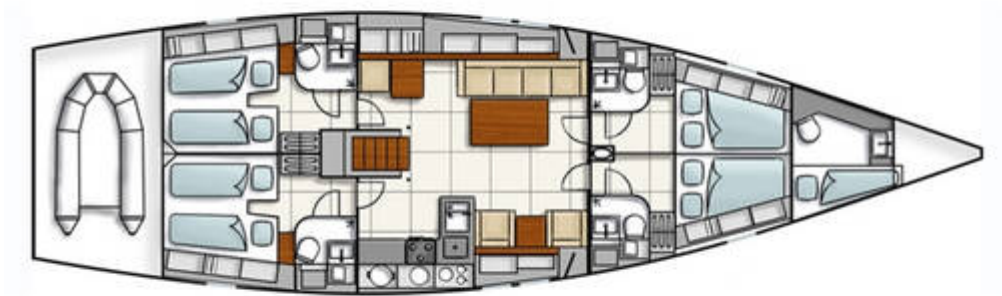

# Mechanical and Rigging

## DIMENSIONS

- LOA: 16.10 m
- LWL: 14.61 m
- Beam: 4.91 m
- Draft (max/fixed): 1.95 m
- Displacement: 23600kgs
- Headroom: 2 m
- Air draft: Aprox. 26.25 m
- Sail area (upwind): Aprox. 155.00 MSq

## CONSTRUCTION

- Type: Cruiser/Racer
- Builder: Hanse
- Model: 540 E
- Passenger capacity : 10
- RCD category : A
- Hull colour : White
- Hull / keel Form: Fin with Bulb
- Rudder type : Spade
- Steering Type: Twin Wheel
- Superstructure materials: Fibre Glass (GRP)
- Deck materials: GRP
- Fuel capacity: 380L
- Water capacity: 2 x 400L
- Holding tanks

## MECHANICAL

- Main engine manufacturer : Yanmar
- Main engine model : 4JH3-DTE - Turbo Intercooler
- Main engine power : 120 hp
- Main engine hours : 2.400 h
- Drive type : Shaft
- Main engine fuel : Diesel

## **ELECTRICAL**

- Generator make: Paguro 6500
- Generator power: 8.5Kw
- Batteries: 18
- Battery charger
- Shorepower system
- Shorepower cable

## **RIG AND SAILS**

- Type of Rig: Fractional
- Material: Anodised Aluminium
- Standing Rigging: Assumed Original
- Running Rigging: Changed When Needed
- Mainsail Reefing: Slab
- Lines lead aft to cockpit
- Stack-pack
- Furling Headsail
- Mast Steps

## **SAILS**

- Main
- Genoa

## **Inventory**

## **DECK GEAR**

- Decking Type: Teak
- Anchor Locker
- Primary Anchor: Lewmar 45kg
- Anchor Chain: 100m x 10mm
- Anchor Windlass: Windex with Remote
- Winches: 1 x Electric 54 AEST, 1 x 54 AST and 2 x 46 AST
- Pushpit / Pulpit
- Swim ladder
- Swim platform
- Cockpit / Deck Shower
- Cockpit Table
- Cockpit Lockers
- Cockpit cushions
- Sunbathing cushions

## **NAVIGATION EQUIPMENT**

- Chart Plotter
- GPS
- Autopilot
- VHF Radio
- Echo Sounder
- Log / Speed
- Wind Instrument
- Wind Indicator at Masthead
- Compass

## **CANVAS**

- Spray hood
- Bimini
- Cockpit Cushions
- Sunbathing Cushions
- Stackpack

## SAFETY EQUIPMENT

- Life raft
- Life Jackets
- Flares
- Fire Extinguishers
- Fire Blanket
- Bilge Pumps: Electric & Manual

## DINGHY

- Dinghy: Aluminium 2.80m
- Dinghy engine: Suzuki 6hp - 4 Stroke (New)

## Accommodation

## INTERIOR/DOMESTICS

- No. of Berths: 4 Doubles & 1 Single
- No. of Cabins: 5 (Including Crew Cabin)
- Headroom: 2m
- Chart Table
- Saloon Table
- Hanging Lockers
- Heating: Webasto
- Air Conditioning: In Saloon
- Number of Heads: 5
- Toilet Type: 4 Electric & 1 Manual
- Shower: 5
- Microwave
- Hob/Oven: Gas
- Galley Sink: Twin Stainless Steel
- Refrigerator/Freezer: Chest and 1 Vertical Fridge 60L
- Water System: Pressurised
- Hot water
- Stereo

## Remarks :

The **Hanse 540E** is a very stylish, fast and comfortable performance-cruiser from the drawing

board of German designer Judel/Vrolijk & Co. With her powerful sailplan, modern hull lines and efficient appendices the **540e** offers sparkling performance and lots of fun on the water. Nevertheless she can easily be handled by a small crew thanks to self-tacking jib and the cockpit layout designed for short handed sailing. The clean, unobstructed decks and the square, low coachhouse profile create a very elegant appearance. Spacious, wide cockpit with two helm stations and free access aft to the electro-hydraulic swim platform. Spacious tender garage below aft deck. Hull in stiff, light and very durable construction in epoxy prepreg.

Well equipped with a 6 kW generator, Webasto heating and AirCon in the saloon.

**Contact:** Port Ginesta 813 08860 Castelldefels Barcelona

**Tel:** [+34] 937978240

**Email:** [info@nybbarcelona.com](mailto:info@nybbarcelona.com)