

Dufour Dufour 500

YEAR 2016 | €329,839 | PLYMOUTH OFFICE



DUFOUR YACHTS - DUFUR 500
H003 - JEAN MARIE LOT / DUFUR

www.dufour-yacht.com
www.jm-lot.com

Summary

Manufacturer: Dufour Dufour 500

Price: €329,839

Location: Plymouth OFFICE

Year: 2016

ID no.: 1010996

DIMENSIONS

- **LOA:** 49' 0" (14.94m)
- **Beam:** 15' 4" (4.67m)
- **Draft:**
- **Keel:** Fin keel

ACCOMMODATION

- **Berths:** 6
- **Cabins:** 3
- **Heads:** 3
- **Showers:** 4

PERFORMANCE

- **Top Speed:**
- **Cruising Speed:**

TANKAGE

- **Fuel:** Diesel
- **Fuel Tank Size:** 600 Litres
- **Water Tank Size:** 791 Litres

MACHINERY

- **Engine Make:** Volvo Penta D2-75
- **Horsepower:** 75
- **Drive Type:** Saildrive



Dufour Dufour 500

Broker Remarks

Standard version, three cabins and three heads
Standard version £194,289 ex VAT
Finance available and part exchange considered! Many optional extras available to accommodate your chosen spec, contact our sales office for a full price list! 01752 605 377 [For the virtual tour click here!](#)

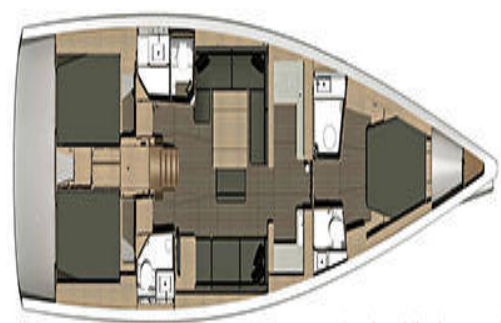

networkyachtbrokers.co.uk

Accommodation:

Interior Finishes:

Woodwork: Real wood veneer in Moabi, solid Moabi (Oak optional)

Floors in Moabi laminate

Doors fitted with twin-bolt anti-vibration locks, cabin doors can be blocked in the open position

Mattresses are in quilted, anallergic fabric

Saloon cushions and cabin mattresses fitted with removable covers

Head-liner lined with wood.

Layout Options:

Three cabins, three heads and an additional shower room (standard version)

Four cabins, three heads and an additional shower room

Glazing and Lighting:

Hull portlights x eight

Coachroof ports x five fixed

Coachroof ports x three opening with curtains

Deck hatches x nine

Indirect lighting under ceiling

Numerous spots and reading lights

Courtesy light, low-level lighting around saloon furniture

Forward Cabin:

Double berth is 200 x 160 cm approx

Mattress is 10 cm thick foam mattress with washable cover

Stowage:

Below berth

Cubby-hole along side of hull

Two x hanging lockers with shelves

Below berth

Two x tidy pockets

Water tank below berth

Access to navigation instrument transducers

Forward Heads:

Manual sea toilet + basin with single-lever

Hot and cold water, chrome-plated brass single-lever mixer tap and shower head
Discharge is direct, via an electric pump
Large mirror
Grating in Corian synthetic resin (std) or teak (option)
Ventilation via deck panel or opening port
Storage unit
Separate shower and toilet

Galley:

Lateral configuration
Corian Synthetic resin worktop with solid wooden fiddles
Stainless, twin bowl sink in stbd module
Hot and cold pumped water with brushed stainless single lever mixer tap
Three burner gas cooker with oven and grill, on gimbles, with stainless hand rail in

12 V refrigerator storage bin. Separation bulkhead port module
Front access to refrigerator. Via the worktop for coolbox
Five x cubby holes to port and four x cubby holes to stbd and under floor stowage
220 V microwave oven in stbd hull cubby hole
Sea water pump built in under the floor to stbd
Waste bin with sort compartments, to stbd

Saloon:

Saloon banquette is U-shaped on the port side
Central banquette slides, with movable back
Three-function saloon table
Stowage under seats and behind backrests
Galley return on stbd side
Four cubby-holes with doors and bookshelf to port and three to stbd
Removable fiddles
Hatches to under-floor stowage
Mast foot is stainless

Chart Table:

One seat with cushions, it can be angled according to heel.
Chart table can be angled according to heel
Ceiling light
Reading light
Storage column below the chart table with a door
Pivoting console that holds the instruments and electrical distribution panel

Aft Heads:

Manual sea toilet
Wash-basin unit with basin in Corian®C synthetic resin
Hot and cold water, chrome-plated brass single-lever mixer tap and shower head
Discharge is direct, via an electric pump
Cupboards, one high-level and two-door storage unit with mirror
Large mirror
Grating is Corian synthetic resin (std) or teak (option)
Ventilation via deck panel or opening port
Head to port and stbd. Separate shower to port

washable cover
Fuel tank under port and stbd berths
Water tank
Stowage, hanging locker with shelves Cubby-
holes along side of hull
Double bulkhead provides acoustic and thermal
insulation from adjoining engine compartment
Technical area between aft berths.

Construction:

Hand-laminated hull in polyester/glassfibre; sides made from vacuum-bonded PVC foam core sandwich
Hull decals grey

NPG gelcoat with first mat impregnated with NPG resin forming an optimum barrier against osmosis

Hull bottom counter-moulded, floors laminated into the hull

Deck is sandwich with injected PVC foam core

Keel bolts bear on stainless back-plates

Rudder is a semi-elliptical shape, filled with closed-cell epoxy foam

Solid stainless steel rudder stock

Non-slip structured deck surface

Solid wood, teak handrails on coachroof

Fixed toe rails in solid teak

Anchor locker is self-draining with built-in windlass support and anchor chain eyebolt, lockable hatch cover

Single retractable anchor roller

Bow pulpits in stainless, opening for easy access and for spinnaker handling

Stern pulpits have a jackstaff bracket, navigation light, and opening life-lines with hook

Stanchions with 2 rows of life-lines

Solid wooden toe-rail



networkyachtbrokers.co.uk

Mechanics:

Engine power 75 hp Volvo Penta D2-75

Sail-drive transmission

Cooling system has a heat exchanger, anti-siphon valve

Sea-water strainer

Fuel tank with gauge on electrical distribution panel

Fuel filter

Emergency fuel shut-off valve

Engine control panel with hours meter, engine stop, and tachometer

Alternator with battery isolator

Ventilation with 2 natural inlets and electric mechanical extract

Separate engine bilge

Access to the engine from front and both sides

Propeller is a three-blade, fixed (std)

Carefully designed foam acoustic and thermal

Cockpit:

Teak laid cockpit bench seats
Teak laid helmsman's seat
One large side locker to stbd with strut-assisted closing and fixing for padlock
Wheel diameter 900 mm
Helm console made of polyester
Engine controls at starboard helm position
Compasses x two on columns
Instrumentation on both port and stbd helm positions
Gas locker under port helmsman's seat
Stern door opens in centre by swinging up
BIB locker under floor, stbd helm position
Tender locker under floor, port helm position
Handrail in stainless, on cockpit table
Shower in aft central section
Shore supply at stbd helm position
Foldaway bathing ladder in stainless steel
Non-slip polyester floor
Emergency tiller with a stainless tiller with deck plate for access

Deck Fittings:

Shroud chainplates on hull sides
Safety harness chainplates in cockpit floor
Backstay chainplates x two
Midships mooring cleats x two in aluminium
Mooring cleat x four in aluminium.
Rubbing strips x six in stainless, on hull sheerline
Fuel deck fillers x two
Water deck fillers x three
Mainsheet tracks on coachroof with adjusting car
Genoa tracks x two, genoa sheet tracks, plunger-adjustable low-lead cars
Downhaul
Through-deck fitting is a stainless swan-neck for electrical and electronic cables
Deck organizers x two,
Four x deck organizers for halyard, sheet, and reef line returns
Halyard winches x two on coachroof
Sheet winches x two at helm positions
Jамcleats x two port/starboard level with the companionway
Furler line jамcleats x one at aft end of sidedeck
Sliding companionway hatch in Plexiglass

Equipment:

Contact

**Network Yacht Brokers (Southwest) Ltd t/a Network
Yacht Brokers Plymouth**

PLYMOUTH OFFICE

Address:

Network Yacht Brokers (Plymouth), Mayflower International Marina, Ocean Quay, Plymouth. PL1
4LS

***Telephone:* 01752 605377**

***Email:* info@nybplymouth.com**



NETWORK

DUFOUR DUFOUR 500

www.networkyachtbrokers.com

