

**LAGOON 380 3 cabin owners version**



**Year:** 2004  
**Location:** Preveza, Greece  
**LOA:** 38' 0" (11.58m)  
**Beam:** 21' 0" (6.40m)  
**Draft:** 4' 1" (1.25m)  
**Remarks:**

**Another boat sold by  
Network Yacht Brokers**

**5,500** Tax Paid

UK+ 44 203 051 0525 / Mob.+306945347870

[nyachtbrokers.com](http://nyachtbrokers.com) | over 700 boats listed

REF: 22F8477530

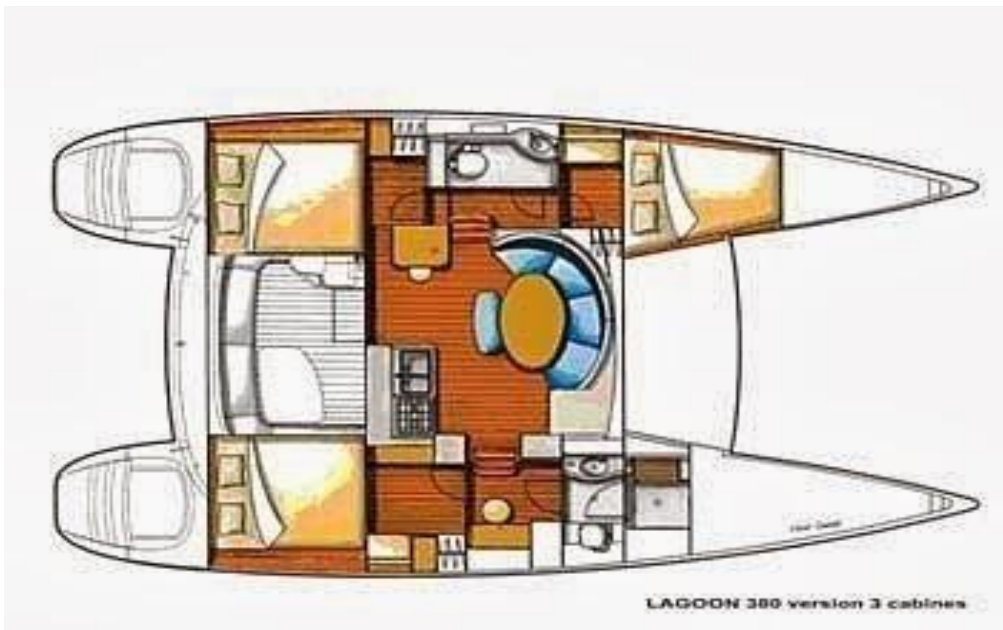

# Mechanical and Rigging

## MECHANICAL

- Main engine manufacturer : Volvo Penta
- Main engine model :2030
- Main engine power : 29 hp
- Main engine hours : 2760 h
- Number of main engines : 2
- Drive type : Sail drive (changed approx 3 years)
- Main engine fuel : Diesel
- Cruising speed : 6 knots
- Maximum speed : 8 knots
- 2x 100 Ltr fuel tanks

## ELECTRICAL

- Shorepower system
- Shorepower cable
- Solar panels:
  - 3x 180AH Domestic batteries 2021
- Fixed pole and electrics for wind generator ( no generator)
- 2 starter batteries 2021
- Battery charger all new 2021

## RIG AND SAILS

- Type of Rig: Fractional
- Spars Make / Material: Aluminium
- Standing Rigging -
- Mainsail Reefing - slab/in-mast
- Lines lead aft to cockpit
- Stack-pack / Lazy Jacks
- Furling Headsail

## SAILS

- Main: Original Good condition
- Genoa: Original Good condition
- 

## DECK GEAR

- Decking Type: GRP
- Anchor Locker
- Primary Anchor

- Anchor Chain / Warp: 70m chain 30m rode
- Secondary Anchor: 2 spares
- Anchor Windlass: Lofrans Tigres 1500w with remote
- Winches Primary:
- Pushpit / Pulpit
- Swim ladder
- Boarding Ladder
- Davits
- Cockpit / Deck Shower
- Cockpit Table
- Cockpit Lockers
- Cockpit cushions
- Wireless windlass remote

## **NAVIGATION EQUIPMENT**

- Raymarine Chart Plotter
- VHF Radio: Furuno
- Echo Sounder: B&G
- Log / Speed: B&G
- Wind Instrument: B&G
- Wind Indicator at Masthead
- Navtex: Furuno
- Compass
- Barometer
- Clock

## **Inventory**

### **CANVAS**

- Sprayhood
- Cockpit Cover
- Bimini
- Cockpit Cushions
- Lazy bag

### **SAFETY EQUIPMENT**

- Life raft:
- Lifebuoys
- Life Jackets: 6
- Danbuoy
- Foghorn
- Radar Reflector
- Fire Extinguishers - #: 2
- Fire Blanket
- Bilge Pump(s) Manual: 2
- Bilge Pump(s) Electric: 2

### **DINGHY**

- Dinghy :
- Dinghy engine

## Accommodation

### ACCOMMODATION

- No. of Cabins: 3
- Chart Table
- Saloon Table
- Heating
- Number of Heads: 2
- Microwave
- Hob
- Oven
- Grill
- Galley Sink
- 
- Water System - pressurised
- Hot water - calorifier
- Stereo
- TV Flat screen
- LED lighting
- DVD player
- Fans in cabins and saloon

### Disclaimer

The Company offers the details of this vessel in good faith but cannot guarantee or warrant the accuracy of this information nor warrant the condition of the vessel. A buyer should instruct his agents, or his surveyors, to investigate such details as the buyer desires validated. This vessel is offered subject to prior sale, price change, or withdrawal without notice.

### Remarks :

Network yacht brokers Lefkas- **Lagoon 380 owners version**- This well-equipped Lagoon offers spacious accommodation a large inventory of extras and has been carefully maintained and updated by the current owner.

This **3-cabin version** dedicates all the starboard hull to the owner with full en-suite facilities (separate shower and toilet). Guests share a combined shower and toilet in the port hull. Direct access to the cockpit from the galley makes for easy living and entertaining. The decks are wide, uncluttered and easy to walk around. This is a safe and very comfortable boat.

Excellent visibility from the helm station, where there is space for two. She is simple to sail



short-handed, with lazy jacks and boom bag for the main; furling headsail; and all lines returning to the helm. The outdoor cockpit area and helm are covered with a Bimini and cockpit table and seating provides a comfortable and well protected entertainment area with easy access to the galley via a large sliding hatch.

The engines are aft and remote from the cabins and are well sound-proofed. Propulsion is aft of the rudders (sail drives) giving a greater performance of the propellers from the twin 29hp Volvo Penta engines.

All spaces are modern, light and well ventilated. She is very comfortable to live aboard, with large beds (king size), ample headroom (1.95m in the main cabin), a simple and efficient layout and great visibility.

#### **HIGHLIGHTS:**

- **Owners Version**
- **Always Privately Owned**
- **Sleeps 6 in 3 Double Cabins**
- **Tender Carried on Davits**
- **Sail Drive Seals Changed (2019)**
- **Solar Panels**

#### **EXCELLENT VALUE, VIEWING HIGHLY RECOMMENDED!**

The lagoon 380 benefits from years of experience from the architects and research and development team at Lagoon. The layout is well thought out with access to the engine bays from the transom large and comfortable cockpit area plus a rigid walkway on the trampoline for ease of access to the forward anchor.

The saloon offers 360 views through the large windows and ease of access to the chart table from the cockpit, the inside-outside flow is also complimented by the bay windows opening wide to allow the chef to pass food directly to dinners.

**Contact:** Network Yacht Brokers Lefkas Cleopatra Marina (Dock side) Aktio-Preveza Ionian Islands, Greece.

**Tel:** UK+ 44 203 051 0525 / Mob.+306945347870

**Email:** [info@nyblefkas.com](mailto:info@nyblefkas.com)