



Amel Super Maramu



Year:	1992	Heads:	2
Location:	Preveza, Greece	Cabins:	3
LOA:	52' 2" (15.90m)	Berths:	7
Beam:	15' 1" (4.60m)	Keel:	Wing Keel
Draft:	6' 7" (2.01m)	Engines:	1

Remarks:

Amel Super Maramu 53 -Accolade is a true Blue-water go anywhere cruising yacht. She has been well maintained and has been lightly used recent years. Despite her size she is easily managed with electric in mast furling main, genoa and mizzen.

£169,950 Tax Paid

E: info@nyblefkas.com **T:** UK+ 44 203 051 0525 / Mob.+306945347870

www.networkyachtbrokers.com | over 700 boats listed

REF: 22676



AMEL SUPER MARAMU

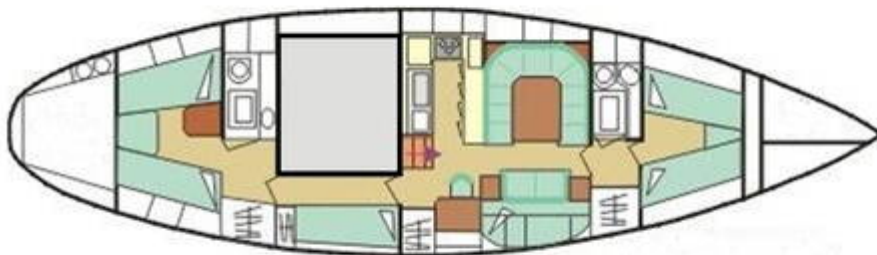

Mechanical and Rigging

DIMENSIONS

- LOA - 15.90
- LWL – 12.60
- Beam - 4.60
- Draft - 2.01
- Displacement - 16,000 kg
- Headroom - 2.0
- Air draft - 20.0
- Sail area - 120.96

CONSTRUCTION

- Type - Cruising Yacht
- Builder - Amel
- Model - Super Maramu
- Hull colour - White
- Superstructure colour - White
- Hull / keel Form - Wing keel
- Rudder type - spade
- Steering Type - Wheel
- Superstructure materials GRP
- Deck materials GRP

TANKAGE

- Water capacity 1000L
- Fuel Tank 600 L

MECHANICAL

- Main engine manufacturer - Perkins - 1992
- Main engine model - Prima M80T
- Main engine power - 80 HP
- Number of main engines - 1
- Date engine last serviced - 2022
- Drive type -Amel Integral Leg Drive
- Propellor(s) type - 3 Blade bronze Feathering
- Main engine fuel - diesel
- Cruising speed – 7kt
- Maximum speed – 8.5kt
- Bowthruster - Amel electric retractable
- Bowthruster HP - 10

ELECTRICAL

- Generator make – Fisher Panda
- Engine battery x 12v - new

- Domestic battery x 4 110ah – 2019
- Battery charger - Victron Energy SKYLCA-TG 24v 50amp
- Inverter - 24v/220v - 600w
- Shorepower system
- Shorepower cable
- Solar panel - Logic STP 20w
- Shore power cable

RIG AND SAILS

Amel Yachts are built to withstand all weather conditions, the concept behind the sail configuration is that they are easy to handle. An electric furling main sail is a major feature of this yacht. The furling motor being installed at the base of the main mast. the furling Motor on the Genoa is mounted next to the sail.

- Type of Rig - ketch
- Spars - Aluminium
- Standing Rigging –Original
- Running Rigging
- Mainsail Reefing – in mast
- Lines lead aft to cockpit
- Furling Headsail

SAILS

- Main – original – fair condition
- Genoa – Crusader - 2017 – Good condition
- Cruising Chute – ballooner – good condition
- Mizzen staysail

Inventory

DECK GEAR

- Decking Type - GRP
 - Anchor Locker
 - Anchors x 4
 - Anchor Chain x 80m
 - Anchor Windlass - Lofrans
 - Winches Primary
 - Winches secondary
 - Pushpit / Pulpit
 - Swim ladder
 - Boarding Ladder
-
- Cockpit / Deck Shower

- Cockpit Table
- Cockpit Lockers
- Anchor washer/deck hose
- Cockpit cushions

NAVIGATION EQUIPMENT

- Chart Plotter – Raymarine
- Radar - Furuno
- Autopilot - Autohelm
- VHF Radio
- Echo Sounder – B&G
- Log / Speed – B&G
- Wind Instrument – B&G
- Wind Indicator at Masthead – B&G
- Compass
- Barometer
- Clock

Accommodation

ACCOMMODATION

- No. of Berths- doubles x 1 - -5 x single
- No. of Cabins x 3
- Upholstery
- Curtains
- Flooring - wooden
- Saloon Table
- Hanging Lockers
- Wet Lockers
- Heating - diesel
- Number of Heads x 2
- Toilet Type - manual
- Shower x 2
- Hob
- Oven
- Grill
- Galley Sink
- Refrigerator & Freezer
- Water System - pressurised
- Hot water – calorifier
- Water maker
- Stereo
- TV
- DVD player

CANVAS

- Spray hood
- Bimini

- Cockpit Cushions
- Cockpit cover
-

SAFETY EQUIPMENT

- Life raft Out of service
- Lifebuoy
- Life Jackets x 6
- Fire Blanket x 1
- Bilge Pump(s) Manual
- Bilge Pump(s) Electric
- Epirb

DINGHY

- Dinghy - Zodiac
- Dinghy engine – Mercury 15, Yamaha 2.5

Remarks :

Amel Super Maramu 53 -Accolade is a true Blue-water go anywhere cruising yacht. She has been well maintained and has been lightly used recent years. Despite her size she is easily managed with electric in mast furling main, genoa and mizzen.

Amel Super Maramu Yacht has become a famous globetrotter, Paomia was designed by Henri Amel & Jaques Carteau. This Yacht was built at Chantiers AMEL in La Rochelle in 1993. An impressive inventory is included for the very reasonable asking price.

GREAT BUY FOR ANYONE SERIOUSLY READY TO PURCHASE A TRUE BLUE WATER – LIVE ABOARD VESSEL

● EU VAT Paid

- Fully equipped Super Maramu with : Bow Thruster & much more- see full specs
- Huge Cockpit – Wide Walk Around Side Decks – Large Fore Deck – Aft Deck
- Aft deck, steps molded into hull to swim platform, SS railings surround entire vessel
- Ketch Rigged for Easy Sail Handling
- In-Mast electric furling for Main -Electric furler for Genoa - Electric winch for Mizzen sail
- All lines led aft for complete control from cockpit
- Well protected CC cockpit with hard dodger, and opening window at helm
- Easy to handle with limited crew
- Numerous storage lockers on deck and in cockpit
- Large Aft Stateroom with Queen Berth & En-suite Head and Shower.
- Forward Guest Cabin Sleeps 2 with en suite
- Additional Pilot Berths in Companionway Leading Aft - and Pull Out in Salon

The Amel Super Maramu 53 is an ideal layout for long range cruising. With the cockpit in the center of the boat (most stable part of the boat), the layout allows for easy access to the galley and salon forward of the cockpit and easy access into the master cabin aft of the cockpit.

She was built to the highest standards by an old world company, and well designed for her intended purpose, and is now available for her next discriminating owner.

Check out Amel story here

<https://www.networkyachtbrokers.com/boat-manufacturer/amel-750/>

Contact: Network Yacht Brokers Lefkas Cleopatra Marina (Dock side) Aktio-Preveza Ionian Islands, Greece.

Tel: UK+ 44 203 051 0525 / Mob.+306945347870

Email: info@nyblefkas.com