

## Beneteau Oceanis 411 Celebration



**Year:** 2003  
**Location:** Preveza, Greece  
**LOA:** 41' 9" (12.72)  
**Beam:** 13' 0" (3.96)  
**Draft:** 6' 5" (1.95)

**Remarks:**

The Beneteau Oceanis 411 Celebration is a beautiful sailboat and an excellent choice for anyone looking for a reliable and comfortable sailboat.

The passion of the Bénéteau team

**Another boat sold by  
Network Yacht Brokers**

**£50,000**

Tax Not Paid

UK+ 44 203 051 0525 / Mob.+306945347870

[nyachtbrokers.com](http://nyachtbrokers.com) | over 700 boats listed

REF: 22654



BENETEAU OCEANIS 411 CELEBRATION

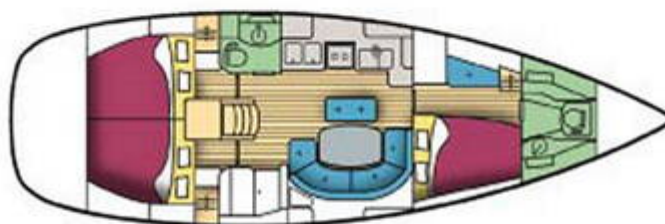

NETWORK YACHT BROKERS

# Mechanical and Rigging

## **DIMENSIONS**

- LOA: 12.72 m
- LWL: 10.10 m
- Beam: 3.95 m
- Draft (max/fixed): 2 m
- Displacement: 10,000 kgs
- Headroom: 1.95 m
- Keel type :FIN
- Built:2003
- REG No.857350
- HIN: FR-BEY76922C303
- Height: 18.63m from waterline
- HULL No.131021190-

## **CONSTRUCTION**

- Type: Fibreglass (GRP)
- Builder: Beneteau
- Model: Oceanis 411 Celebration
- RCD category : A
- Hull colour : White-Blue Gold trim
- Superstructure colour : White
- Hull / keel Form: Fin
- Rudder type : Spade
- Steering Type: Wheel
- Superstructure materials: GRP
- Deck materials: Moulded GRP
- Hull finish : Gelcoat

## **TANKAGE**

- Fuel capacity: 250 litre
- Water capacity: 350 litre
- Holding tanks : 1 x plastic

## **MECHANICAL**

- Main engine manufacturer : Volvo
- Main engine model : D2-55
- Main engine power : 55 hp
- Main engine hours : 3,600 h
- Number of main engines : 1
- Date engine last serviced: 2021
- Drive type : shaft
- Propellor(s) type: 3 bladed folding
- Cooling (Fresh water /sea water: both
- Main engine fuel : Diesel
- Cruising speed : 6 knots

- Maximum speed : 7.5 knots
- Bow thruster: Side power SE 60
- Schenker 12V Water Maker

## **ELECTRICAL**

- Bow thruster Battery: (2018) 75 ah
- Engine battery : 95 Ah
- Domestic battery : 2x 140 ah (2019)
- Battery charger
- Shorepower system
- Shorepower cable
- Solar panels: 4x 85 Watt mounted on Stainless Steel gantry
- Charging: 50 amp Alternator, 15 amp solar panels and 60 amp shore power battery charger

## **RIG AND SAILS**

- Type of Rig: Bermudian Sloop
- Spars Make / Material: Z spars
- Standing Rigging - 2017-Replaced by Beneteau dealer in Italy
- Running Rigging Updated as needed -in good cond.
- Mainsail Reefing - Slab reefing
- Lines lead aft to cockpit
- Stack-pack / Lazy jacks
- Furling Headsail
- Spinnaker Pole (Mounted at mast)

## **SAILS**

- Mainsail: fully battened Incidence performance sail on ball bearing luff. Slab reefing.
- Genoa: 140% with roller furling (Facnor)
- Zip pack sailing bag with lazy jacks.
- All lines lead to cockpit.
- All halyards Dyneema low stretch

-

## **DECK GEAR**

- Decking Type: Moulded GRP
- Anchor Locker: Large deep
- Primary Anchor : Rochna 20KG
- Anchor Chain / Warp: 70 M x 10 MM
- Secondary Anchor : Kedge 18 KG
- Anchor Windlass: Lofrans Tigre 1500 Watt
- Winches Primary: Lewmar
- Pushpit / Pulpit
- Swim ladder
- Boarding Ladder
- Swim platform
- Gantry : Stainless steel

- Cockpit / Deck Shower
- Cockpit Table: GRP and wood folding centre consol
- Cockpit Lockers: 4
- Cockpit cushions
- Passarelle : Plank

#### WINCHES AND DECK EQUIPMENT:

- 2 self tailing Lewmar genoa winches.
- One electric Lewmar 40 halyard winch mounted on coachroof.
- One Lewmar halyard winch mounted on coachroof.
- Adjustable genoa cars.

#### **NAVIGATION EQUIPMENT**

- Steering compass
- Raymarine series 6000 instruments,
- Auto pilot Raymarine ST 6001
- Raymarine tridata (depth, speed, log)
- Raymarine wind speed and direction
- Raymarine colour chartplotter
- Raymarine 623 radar and plotter
- Icom VHF DSC radio
- SatCom C communication system

#### **DECK**

- 20 Kg Rocna Style Main Anchor With 70m Of Calibrated 10mm Chain
- Brittany 18kg Kedge Anchor With Chain And Warp
- Electric Anchor Windlass (Lofrans Tigre 1500 Watt)
- Dodger
- Bimini

#### **GENERAL ITEMS**

- 2 X Boat Hooks
- 6 X 10 Litre Spare Fuel Drums And Siphon Hose
- 10m Flat Hose
- 15 M Flat Hose
- 20m Reinforced Hose
- Sundry Hose Clamps/Fittings
- 15m 240 V Extension Cord
- Sextant
- 2 Short Warps
- Bag Of Sundry Ropes
- Navigation "Shapes"
- "Trip Line" Buoy
- Lead Line
- 2 Waterproof Torches
- Emergency Navigation Light Set
- "Rust Remover" 6 Litres

#### **SAFETY**

- Zodiac 6 Person Liferaft To Meet Cat 1 Safety Requirements
- 7 Lifejackets And Integral Harness Systems

- Horseshoe
- Flares; Fog Horn;
- Fire Extinguishers X 2
- Manual And Electric Bilge Pumps
- Basic First Aid Kit With Sterile Dressings And Bandages, Band Aids, Dettol Antiseptic, Cotton Wool And Throat Lozenges.
- Bolt Cutters
- Bosun's Chair
- Tool Kit And Spares

**General Note on Safety Equipment:** Any safety equipment such as liferafts, fire extinguishers and flares etc. are usually personal to the current owner(s) and if being left on-board as part of the sale of a used vessel may require routine servicing, replacement by the new owner and not to be used in any negotiations on price.

## **OUTBOARD**

- 6HP 4 Stroke Mercury Outboard  
(No dingy included)

## **SPARES / MAINTENANCE**

- 1 Prop Shaft Anode
- 1 Engine Oil Filter
- 2 Engine Fuel Filters
- 2 Engine Fan Belts
- 3 Engine Impellers
- Main Sail Head Board
- Hacksaw
- Small Tool Kit - Screw Driver
- Plug Spanner
- Pliers
- Silicon / Mastic New Cartridge And Gun
- Wood / Fibreglass Hole Saw
- Various Electrical Spares And Tie Straps
- "Wooden Plug" Hole Repair Set (Useful For Clearing A Blocked Holding Tank)
- 6 M X 16mm Reinforced Hosing - Spare For Watermaker
- 5 Litres Engine Coolant
- Pressure Pack Can "CRC"
- Various Greases and Oils

## **PAINT**

- Antifouling Touch Up Paint
- Undercoat
- 75 Mm Paint Brush
- Roller Tray And Roller Frame
- Masking Tape
- Sanding Pad And Various Sand Papers
- Varnish Repair Kit - New Wood Filler And Spray Varnish
- Antifouling Undercoats Are Hempel, With Boero Admiral 933 Top Coat In 2016

## **BARBECUE**



- Magma Party Size S/S Marine Barbecue
- Magma Mounting Bracket For 25mm Rail
- Low Pressure Weber Gas Regulator
- 5kg Camping Gaz "Double" Gas Tank
- Hosing and Fittings

## **TENDER**

- Dinghy Anchor
- Repair Kit
- Spare Petrol Drum
- S/S Chain And S/S Padlock

## **BIKES**

- 1 X Dahon Helios P8 Folding Bike U6 Alloy Frames
- 8 Speed Shimano Gears
- "Biologic" Comfort Saddles
- 2 Helmets (Used But Ok)
- Heavy Duty Long Cable Bike Lock
- Puncture Repair Kit
- Pump
- (Note: This Model Is A Performance Model That Does Not Have A Carrier Rack Or Panniers)

## **OTHER**

- 100m X 15mm Braided Rope - Useful In Emergency As Tow Line/ Spare Sheets/"Stern To" Line
- New Volvo 50 Amp Alternator - Spare For Emergency Use
- Rebuilt Engine Fresh Water Pump – Spare For Emergency Use
- Link 10 Battery Monitor
- 12 V Bosch Drill
- Heavy Duty Pipe Wrench
- 2,000,000 Candlepower Rechargeable Spotlight - Gelcell Battery
- 2 X XTS Spinlock Jam Cleats
- Standard Brass Sea Cock
- Standard Brass "Skin Fitting"
- Heavy Duty (80 Kg) Folding Trolley - Carrying Heavy Groceries/Fuel/Grog Etc

## **Accommodation**

Her accommodation is very good indeed for her size. The saloon and galley are spacious and well laid out for comfortable living, as is the very sociable cockpit.

The large forward double cabin has an ensuite heads/shower room and there are two large double cabins aft with an additional heads/shower room.

- No. of Berths- doubles/singles: 3 doubles

- No. of Cabins: 3 doubles
- Headroom: 1.95
- Upholstery- Navy Benteau pattern -Very good cond.
- Flooring: Teak & Holly- Good
- Midships WC On Port Side With Basin, Shower And Holding Tank
- Pressurised Hot Water- Engine and Emersion
- Deck Shower (Hot/Cold)
- Large Saloon, With 1.95m Headroom
- All Internal Upholstery Fabric (Reps Blue) Very Good Condition
- Saloon: Double Bed Conversion Pack
- Chart Table And Storage On Starboard Side

## GALLEY

2 Burner Gas Hob  
Oven  
Refrigerator 220L  
Fully compliment of cooking utensils included

## Remarks :

**Beneteau Oceanis 411 Celebration.** This Finot design has truly set a new standard for ocean cruising yachts, both in terms of design, performance and in terms of construction and equipment: fast, elegant and spacious with three cabins. This **Celebration** version, which offers among others an extended mast, a more powerful engine, is in excellent condition, perfectly maintained by the owners at a professional level.

## HIGHLIGHTS below but included in the specification:

- \* Always private
- \* Same ownership from new
- \* New Standing Rigging (2017)
- \* Engine serviced every 100 hours
- \* Water Maker
- \* Bow thruster
- \* Winter cover
- \* Large inventory including spares

The yacht is currently ashore at Prevea, Greece and available for viewing by arrangement with Network Yacht Brokers

## From the Manufacturers Brochure:

After the **Clipper** version of the world best seller in the over 40' yacht range, this special edition **Oceanis 411 Celebration** is offering:

- For extra performance upwind, downwind and motoring: a taller mast, larger and more powerful sails, upgraded deck and mast fittings, high torque-low noise diesel engine with a 3 blade folding propeller.



**Contact:** Network Yacht Brokers Lefkas Cleopatra Marina (Dock side) Aktio-Preveza Ionian Islands, Greece.

**Tel:** UK+ 44 203 051 0525 / Mob.+306945347870

**Email:** [info@nyblefkas.com](mailto:info@nyblefkas.com)