

## Princess 38 Fly



**Year:** 1984  
**Location:** Preveza, Greece  
**LOA:** 38' 1" (11.60m)  
**LWL:**  
**Ballast:**  
**Designer:** Princess M  
**Beam:** 13' 0"  
**Draft:** 2'

**Heads:**

**Cabins:**

**Be:**

**Remarks:**

Princess flybridge cruiser. Two cabins, two guest heads. The saloon also converts for an office. The current owner is a marine engineer. She has just

**Another boat sold by  
Network Yacht Brokers**

**59,950**

Tax Paid

**Phone:** UK+ 44 203 051 0525 / Mob.+306945347870

**Website:** [networkyachtbrokers.com](http://www.networkyachtbrokers.com) | over 700 boats listed

REF: 22618



*PRINCESS 38*

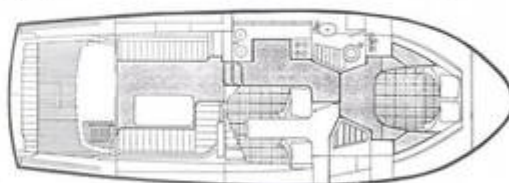

## Mechanical and Rigging

### CONSTRUCTION

- Princess 38 1984
- Built by: Princess Yachts , Plymouth
- LOA : 11.6m
- Draft : 1m
- Construction materials :GRP
- Deep V Planning Hull with trim tabs
- Flybridge

### MECHANICAL & ELECTRICAL

- Twin Volvo TAMD 60C 255hp each
- Hours: approx 2,900 hrs each
- Starboard Engine Overhauled 07/2021 (Cost 10,000€)
- All Filters Renewed in Both Engines 2021
- Shaft driven
- Cruising Speed 15-18 knots
- Top Speed 25 knots
- Recent works:
- 2 turbos 2020,  
2 oil coolers 2017/18, inter coolers and heat exchangers cleaned out and serviced,  
2 new stainless exhaust elbows 2018/20 and all new piping 2018,  
2 new alternators with Sterling Splitter Diode 2020, stop control buttons fitted to both helms 2020
- Regularly serviced by professional diesel engineer owner
- Engine Batteries x 2
- Domestic Batteries x 3 Varta Silver 2020
- Sterling Pro Charge Ultra 30A charger 2016
- 3 x Solar panels, 310 watts in total with new Victron 100/20 MPPT Bluetooth controller 2020
- NASA Battery monitor
- 300w Inverter
- Shore power cable

### TANKAGE

- Fuel :1100ltrs total in two tanks
- Water : 500ltrs
- Holding Tank with macerator new 2020

### DECK

- Main Anchor: Delta
- Chain:10mm x 55M plus 20m anchor plait
- Second Anchor: Danforth kedge anchor
- Windlass: Lofrans Tigres - new brushes 2018, with wired and wireless remotes and controls at both helm positions
- Salt water deck wash 2020

- Summer bimini to aft cockpit new 2020
- Winter bimini with enclosed cockpit tent
- Cockpit cushions 2020, chairs and tables
- Stainless steel BBQ
- Summer and winter saloon window covers
- Fenders, lines and boathooks
- Aluminium and wood passarelle
- Davits
- Bathing Platform with extension, ladder and fresh water shower

## **FLYBRIDGE**

- Some instrument repeaters
- New throttle controls 2020
- Bimini
- Generator box

## **Inventory**

### **NAVIGATION**

- 2 x compasses
- NASA depth sounder
- Raymarine C80 Radar/Plotter
- Full size chart table
- Cetrek Autopilot fitted but not currently working
- Demek VHF radio
- Furuno GPS to flybridge

### **SAFETY**

- Flares new 2020
- Fire Extinguishers x 5 new/ serviced 2020
- Fire blanket in galley
- Gas safety cut off valve
- Foghorn new 2020
- Electric automatic bilge pumps x 3 aft/midships/forward
- Manual Henderson Mk V bilge pump
- Lifebuoy
- Fixed and Remote spotlights
- Navigation lights
- Lifejackets

### **TENDER**

- Nautend RIB with sun cover

## **Accommodation**

## ACCOMMODATION

- 6 berths in 2 cabins and saloon
- 1 x double with hanging locker and chest of drawers
- 1 x twin with hanging locker and chest of drawers
- 1 x heads with shower, shaver point, solar fan 2020, Jabsco toilet 2020
- 1 x en suite heads with shower, shaver point, Jabsco toilet 2016

## DOMESTIC

- Hot water calorifier with pressurised water system
- Vitrefrigo C115i 12v fridge 2017 with 17 litre freeze box and digital controller
- Gas cooker with 4 burners and oven/grill (2018)
- New Gas Pressure Regulator (07/2021)
- Cooker fan extractor overhead
- Twin sinks in galley
- 220v microwave
- Filtered drinking water tap 2020
- 12v TV with integral DVD player , external TV aerial
- Stereo radio with USB and Aux sockets
- Candy 3.5kg automatic washing machine
- USB charging points to guest cabin and saloon
- Re-upholstered and new curtains 2017
- LED lighting throughout

Remarks :

### Princess 38 Flybridge

A lovely example of a spacious Princess flybridge cruiser.

Master cabin forward with a central double bed, guest cabin to starboard with twin berths  
Two heads are better than one, so the saying goes, and this boat proves it, with private facilities on offer for each cabin, the guest heads doubling up as a day toilet.  
The galley to port side is spacious and well equipped with new wood style flooring.  
She is easily managed getting in and out of port from the flybridge and the twin Volvos 255HP can push her along at up to 25 Knots or cruise economically at around 15 knots.

The saloon also converts for an additional two berths.  
This boat has been well maintained and upgraded.  
Perfect live aboard and would be ideal for remote working. The previous only owner had owned her from new and had her delivered to Greece where the VAT was paid.

**Full details are in the specification section but her highlights include:**

- Flybridge
- Well maintained mechanically
- Cockpit tent-great for winter living onboard
- Summer Bimini to aft cockpit new 2020
- Winter Bimini with enclosed cockpit tent
- Twin Volvo TAMD 60C 255hp each (only 2,900 hours)
- She is EU VAT Paid (Greece) Original documents

**The Princess 38 Fly provides comfortable cruising she is ashore at Preveza, Greece after a summer cruise and is ready for inspection.**

Viewing by appointment David +30 6945347870

**Contact:** Network Yacht Brokers Lefkas Cleopatra Marina Preveza 48100 Ionian Islands Greece

**Tel:** UK+ 44 203 051 0525 / Mob.+306945347870

**Email:** [info@nyblefkas.com](mailto:info@nyblefkas.com)