

Jeanneau Sun Odyssey 50 DS (Owners version)



Year: 2008
Location: Preveza, Greece
LOA: 48' 5" (14.75m)
Beam: 14' 9" (4.55m)
Draft: 7' 6" (2.3m)

Remarks:

This Jeanneau Sun Odyssey 50 DS is a very well equipped boat and has been owned by a couple and his wife in the South of France; she has been used as a weekend cruiser. This owner's version layout boasts a double forward cabins.

**Another boat sold by
Network Yacht Brokers**

1,000 Tax Not Paid

UK+ 44 203 051 0525 / Mob.+306945347870

nykyachtbrokers.com | over 700 boats listed

REF: 22598



JEANNEAU SUN ODYSSEY 50 DS
Owners Aft Stateroom plus 2 Doubles Fwd

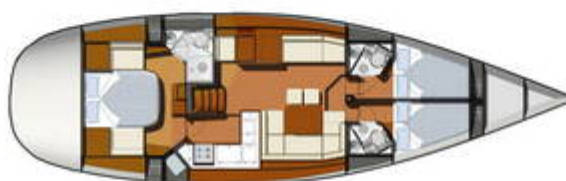

NETWORK YACHT BROKERS



Mechanical and Rigging

DIMENSIONS

- LOA : 14.75m
- LWL : 13.12m
- BEAM: 4.49m
- DRAFT: 2.15m
- DISPLACEMENT: 13400KG (light load)

CONSTRUCTION

- TYPE: Cruiser
- BUILDER: Jeanneau (FRA)
- MODEL: Sun Odyssey 50 DS
- YEAR: 2008
- PASSENGER CAPACITY : 12
- HULL COLOUR : Awlgrip Flag Blue
- HULL / KEEL FORM: Fin with bulb
- RUDDER TYPE : Spade
- STEERING TYPE: Twin Lewmar wheels
- HULL: GRP - Epoxy base coat from new to prevent osmosis* and Coppercoat* (new 2016)
- THROUGH HULL FITTINGS: all seacocks replaced in 2016 with corrosion resistant type*
- DECK MATERIALS: Teak decks, cockpit seats and cockpit table
- FUEL CAPACITY: 1 x 237 litres
- WATER CAPACITY: 613 litres (tanks fore and aft)
- HOLDING TANKS : 1 x for master cabin

MECHANICAL

- MAIN ENGINE MANUFACTURER : Yanmar
- MAIN ENGINE MODEL : 4JH4-HTE turbo charged*
- MAIN ENGINE POWER : 110hp
- ENGINE HOURS : Approx 1,600
- GEARBOX: Yanmar ZF 30M
- Engine hours: about 1600
- COOLING SYSTEM: Salt and fresh water via heat exchanger
- NO. OF CYLINDERS: 4
- DRIVE TYPE: Shaft Drive
- PROPELLOR(S) TYPE: 3 Blade 20" Flexofold self folding
- ROPE CUTTER: stainless steel cutter on shaft
- MAIN ENGINE FUEL: Diesel
- FILTERS: Extra Racor Turbine 500FG diesel filter* with vacuum gauge and manual feed pump*
- BOW THRUSTER: Max Power*

ELECTRICAL

- ENGINE BATTERY : 1x Optima Red Top RTS 4.2 50Ah
- DOMESTIC BATTERY : 4x Rolls 155Ah = 620Ah* (new 2019)

- BOW THRUSTER BATTERIES: 2 x Optima Red Top RTS 4.2 (new 2019)
- BATTERY CHARGER : Victron Phoenix Multi Plus* 12v / 3000W / 120 Amp with remote control panel* (new 2019), powerful enough to run washing machine at sea
- BATTERY MONITOR: Smartgauge*
- BATTERY CHARGE SPLITTER: Smart Bank*
- SHORE POWER: Cable and consumer unit
- SOLAR PANELS: 2x 85w Kyrocera with Victron BlueSolar MPPT charge controller*
- ALTERNATORS
 - - 1x Mastervolt heavy duty large case 130A* (additional)
 - - 1x Hitachi 80A (standard)

RIG AND SAILS

- TYPE: Sloop, with removable adjustable inner forestay* and twin backstays
- MAST / BOOM CONSTRUCTION: Sparcraft Aluminium
- STANDING RIGGING: Stainless Steel wire, Detachable inner forestay*
- MAINSAIL REEFING: Slab reefing with Railman 4000 batten cars*
- GENOA FURLING SYSTEM: Facnor LS290
- MAINSAIL: 50m2 Fully Battened with Lazy bag*
- GENOA : 63m2 140% with Harken tracks
- OTHER : Storm jib*
- SPINNAKER KIT: All mast and deck gear including pole, guys, sheets, halyard*

Inventory

DECK GEAR

- Significantly upgraded anchoring kit for serious cruising:
- DECK : Teak decks, cockpit seats and cockpit table
- FOCSSLE : with full headroom, ladder and light
- ELECTRIC WINDLASS : Lewmar V4/V5 with Quick chain counter and extra remote control from cockpit*
- BOW ANCHOR : 40kg Rocna* with 80m of 10 x 30mm HDG chain* (new 2021)
- KEDGE ANCHOR: Aluminium Fortress FX55* with 10m chain plus 100m 18mm Octoplat Nylon
- PRIMARY : 2x Harken 60 2 speed self tailing sheet winches
- COACH ROOF : 1x Harken 44 Electric* 2 speed self tailing halyard winch to port; 1x Harken 44 2 speed self tailing to starboard,
- FLOATING SHORE LINE: 100m Kapa Flex Polypropylene*
- UPGRADED DECK MOORING CLEATS* (upgraded to larger size)
- FENDERS : x11
- BOARDING LADDER : Transom ladder. Teak and aluminium Passerelle*
- BATHING PLATFORM : Teak, with locker for life raft and spare fuel cans underneath
- TRANSOM SHOWER : Pressurised hot & cold freshwater
- Numerous spare blocks, winch handles, etc

NAVIGATION

- LOG / SPEED / DEPTH : Raymarine ST60
- GPS : Raystar RS125 receiver
- VHF / DSC : Raymarine 55E

- AUTOPILOT / SELF STEERING : Raymarine ST6002 with Leccombe & Schmidt hydraulic ram*
- CHART PLOTTER : Raymarine E120 (helm station)*
- WIND INDICATOR : Raymarine ST60 plus Windex
- AIS : Digital Yacht AIT1000 Class B*
- COMPASS : 2x Plastimo Steering compass for each wheel
- WIRELESS REMOTE CONTROL : Raymarine Wireless Smart Controller for autopilot*

CANVAS

- BIMINI: All Canvas In Dune Colour*
- SPRAY HOOD: All Canvas In Dune Colour*

SAFETY EQUIPMENT

- ALARM - Nautilarm Extreme with remote control and reporting via SMS to mobile phone. Range of sensors include GPS GeoFence, PIR to detect intrusion, low voltage, bilge pump activation, etc*
- BILGE PUMPS: x2 Auto electric, and manual in cockpit
- FIRE EXTINGUISHERS: 2
- FIRE BLANKET: 1
- LIFEBOUY : 1
- DANBUOY : Inflatable
- EMERGENCY TILLER : Steel
- LIFE RAFT : (needs service)
- MAST CLIMBING KIT

Note: Any safety equipment such as liferafts, fire extinguishers etc if being left on-board as part of the sale of a used vessel may require routine servicing, replacement by the new owner and not to be used in any negotiations on price.

DINGHY

- DINGHY : X 1 2.9m* (New 2019)
- OUTBOARD ENGINE : 3.5Hp Tohatsu*

Accommodation

INTERIOR/DOMESTICS

- BERTHS : 8 (2 in main saloon where table lowers to form extra double berth)
- CABINS : 3x double, each with own ensuite WC, shower & basin
- LAYOUT : master cabin aft, 2 guest cabins forward (port & starboard)
- EXTRA CARPENTRY : many extra shelves, book cases, seats to maximise use of space for cruising*
- WASHING MACHINE : full size Brandt Malice 240v*
- WATERMAKER : Spectra Newport 400 reverse osmosis with auto flush computer*
- REFRIGERATION : Vitrifrigo 12v 180lt with freezer compartment
- LARDER & Cool box
- COOKER : 4 burner ENO, with grill / oven*
- MICROWAVE : Space for microwave in locker with wiring ready for installation

- **PRESSURISED WATER SYSTEM** : Hot and cold
- **MANUAL WATER SYSTEM** : Foot pump in galley sink for either fresh or sea water*
- **CALORIFIER / IMMERSION** : Both, Quick Nautic, 40l
- **GALLEY EQUIPMENT** : Fully equipped*
- **NUTRI-BULLIT** juicer / liquidiser
- **GAS BOTTLES** : 1x connected and 1x spare in ventilated cockpit locker
- **HEATING SYSTEM** : 2x Webasto Air Top 3500 diesel heaters*
- **VENTILATION** : 5x Caframo Bora fans*
- **HIFI** : with cockpit and saloon stereo speakers*
- **SCREENS** : Sun and insect screens by Oceanair
- **DEHUMIDIFIER** : Portable 240v*
- **WATER FILTER** : for shore water*
- **HAIRDRIER**
- **IRON**
- **Samsung TV / Monitor** that can be rotated to suit viewing angle*

Remarks :

Jeanneau Sun Odyssey 50 DS commissioned from new by the current (only) owner in the South of France.

This owner's version layout boasts a very impressive aft owner's cabin with a spacious en-suite plus two large double forward cabins. This is a great example of the popular 50 DS with the most sought after layout. She is presented in exceptional condition.

Jeanneau's careful refinements of the **50 DS Deck Saloon** layout have caught on with its customers. Although the company has built **DS (Deck Saloon)** models as small as 39 feet, the design approach really comes into its own when the yacht is **50** feet or larger. Philippe Briand designed her high-performance hull, while the Garroni Designers lent her an elegant style. Together, they have conceived the ideal sailboat to meet your every expectation: fluid lines, design and construction certified by the Bureau Veritas, a streamlined keel and appendices for excellent performance at sea, and the comfortable, modern interior of a new generation of **Sun Odyssey** .

While the yacht's features are optimized for coastal cruising, it is quite capable of crossing an ocean. Moderately light displacement helps make it fast in light winds, while the sturdy construction makes it capable of getting to the next port in fine style no matter what the weather

Full details are in the specification section but her highlights include:

- One Owner from New
- Never Chartered
- Only Used for Family Cruising - Never Raced
- Part one registration Jersey "Certificate of British Registry"
- Ashore For 8 Months of The Year
- Engine: Yanmar 110hp 4JH4-HTE Turbo Charged
- Bow Thruster-Max Power

- AWLgrip "Flag Blue" Topsides
- Full Size Brandt Malice 240v Washing Machine
- Spectra Newport 400 Watermaker
- 2x Webasto Air Top 3500 Diesel Heaters
- Nautilarm Extreme Alarm
- Full Service and Maintenance Log Available

She is currently afloat after a short summer cruise providing a chance to check all her systems.

EXTRA PHOTOS AND BROCHURE (Copy and paste the link below)

<https://drive.nyblefkas.com/external/ac867bcf95af15fe443ed345806bdf4bdebde3f42a3e1f19b06e601df93>

Viewing by appointment Network Yacht Brokers Lefkas info@nyblefkas.com

MORE DETAILS:

The raised sole amidships opens up the primary living spaces while providing usable stowage beneath, even when the hull form is relatively shallow, as this one is. The saloon area is generous, and the full galley includes fridge and separate freezer. More than adequate seating surrounds the saloon table and opposite along the separate Settee. The whole saloon is light and bright thanks to the large deck saloon windows and deck skylights and equally can be closed off for privacy and sun protection.

You will appreciate the ease of handling this large seafaring sailboat. The three-part cockpit features twin steering wheels at the helm, an open-air saloon with comfortable bench seating for entertaining around a generously sized cockpit table, and an additional lounge area for relaxing while underway. Large winches and a powerful electric windlass facilitate handling.

Contact: Network Yacht Brokers Lefkas Cleopatra Marina (Dock side) Aktio-Preveza Ionian Islands, Greece.

Tel: UK+ 44 203 051 0525 / Mob.+306945347870

Email: info@nyblefkas.com